

SP204

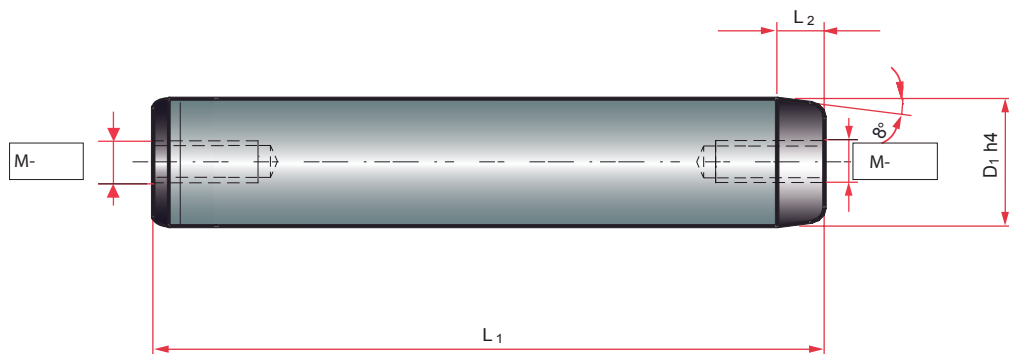

Guide pillar
Columna guía lisa



Up to $\varnothing 30$ - 1.7131 (16MnCr5) – Cemented / Bigger than $\varnothing 40$ - 1.1191 (Ck 45) – Induction / Hardness: 60+4HRC
Hasta $\varnothing 30$ - 1.7131 (16MnCr5) – Cementado / Superior a $\varnothing 40$ - 1.1191 (Ck 45) – Inducción / Dureza: 60+4HRC

D_1	L_2	L_1	Qty.

Notas.